

| L | 29.8 | 41.0 | 51.9 | 62.5 | 73.3 | 83.9 |
|---|------|------|------|------|------|------|
| C | 10.0 | 20.0 | 30.0 | 40.0 | 50.0 | 60.0 |
| D | 10.1 | 10.9 | 12.7 | 12.2 | 13.7 | 15.7 |
| E | 4.1 | 5.1 | 6.7 | 6.2 | 7.7 | 9.7 |
| F | 5.6 | 2.9 | 2.3 | 3.0 | 2.5 | 2.4 |

OPCJA



Kod 5090.1111



Kod 5090.1110

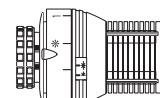

Kod 5090.1119



Kod 5094.425



Kod 5094.427

Kod 5090.1111

Standard

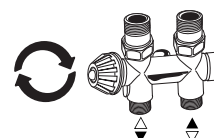
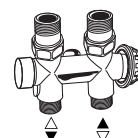

Złącza do instalacji znajdziesz w katalogu Jaga
www.jaga.com.pl

UWAGA

Aby zagwarantować moc grzejnika Jaga zaleca stosować rurki o średnicach 16/2, 18/1 or 18/2.

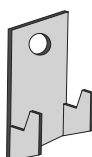

x 4



x 4



Ze względów bezpieczeństwa kołki rozporowe nie są dostarczane w komplecie. Dobierz odpowiednie kołki do swojej ściany.

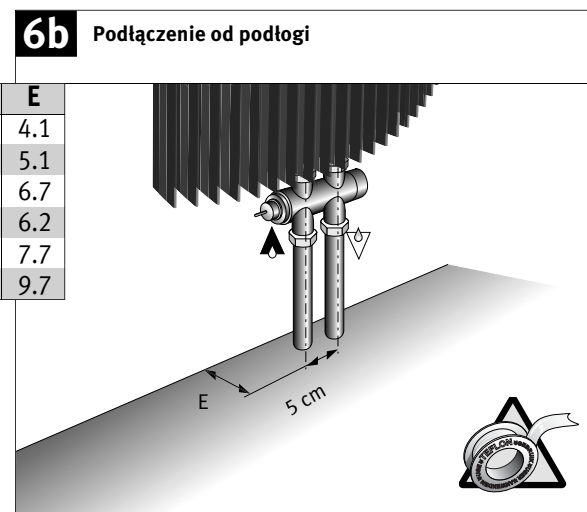
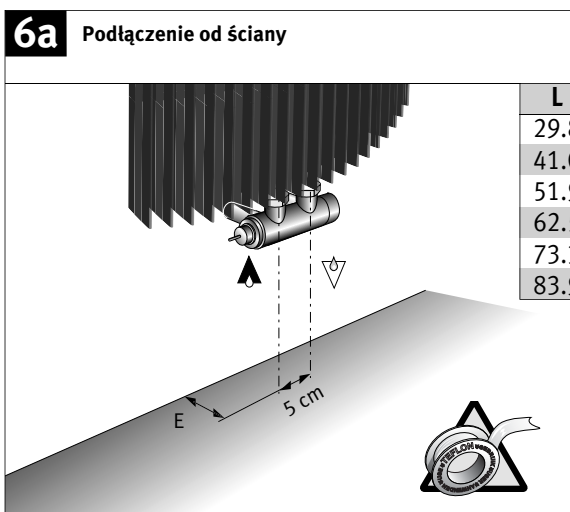
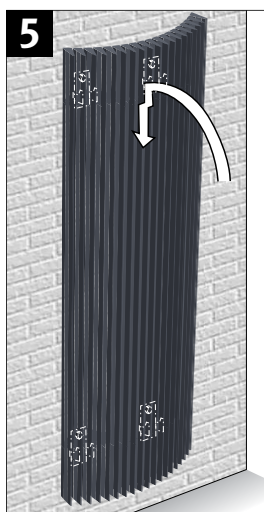
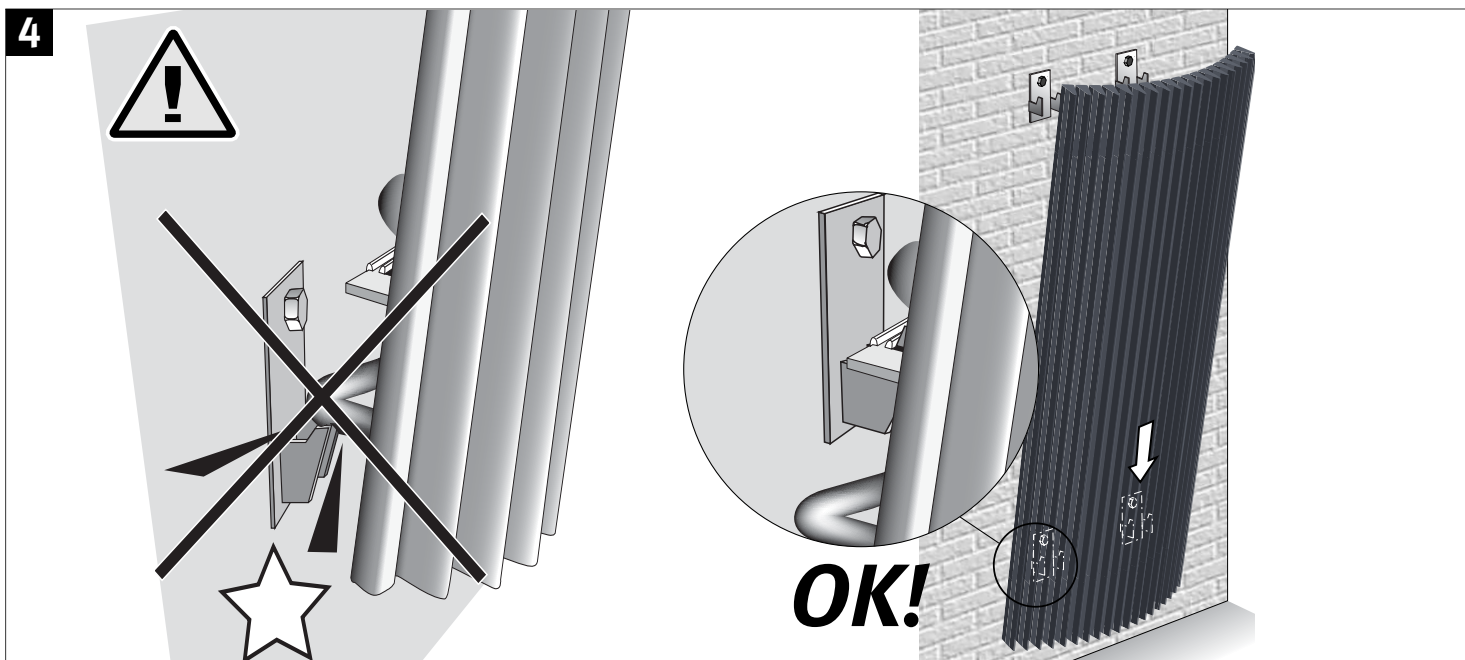
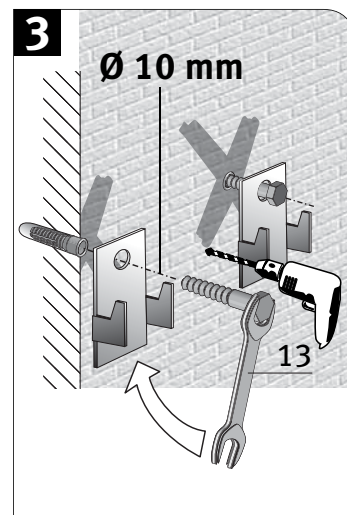
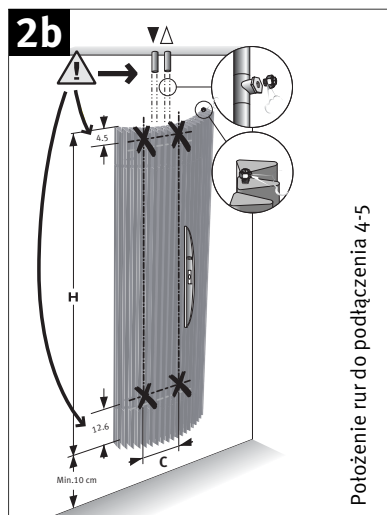
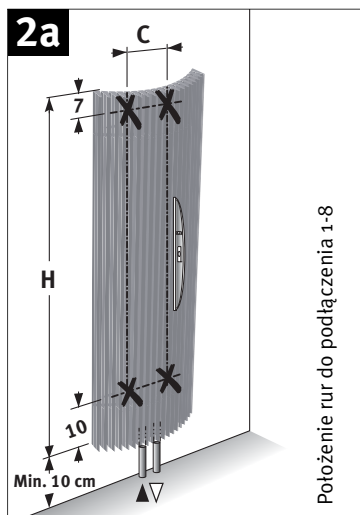
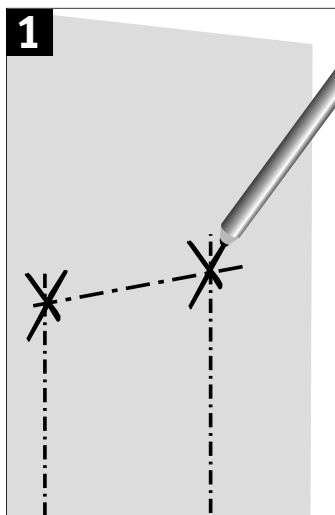

Podłączenie do instalacji jedno- lub dwu-rurowej

